

XD3-40d

4 inch Direct Thermal
Desktop Label Printer

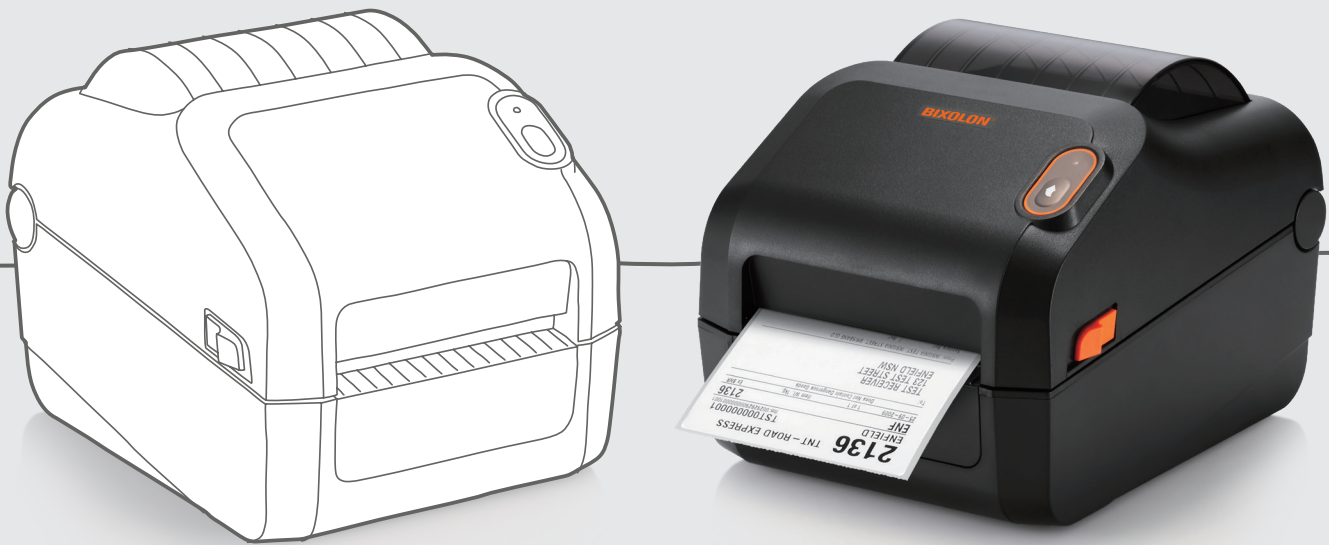

Compact and Affordable



Basic Functions

- Printing speed up to 5 ips (127 mm/sec)
- Fully compatible with market-leading programming languages
- Supporting stand-alone configuration mode by visual LED
- Smart switch programming languages without setting the mode

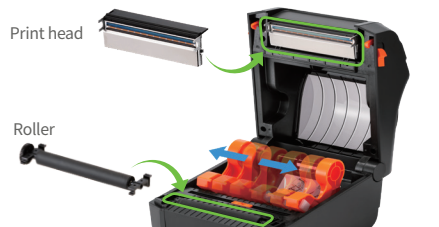

User-Friendly Design

- Easy paper loading with adjustable paper guide and holder
- Simply set up media sensor
- Optional peeler
- Compatible with label design software; BIXOLON's Label Artist™, Seagull's BarTender® and BarTender® UltraLite for BIXOLON

Standard



Optional



All in one Plus™ Interface

- Standard: USB
- Optional: USB + Serial + Ethernet

XD3-40d

4 inch Direct Thermal Desktop Label Printer

Specifications

Printer Specifications

Print Method

Direct Thermal

Print Speed

Up to 5 ips (127 mm/sec)

Print Resolution

203 dpi

Print Width

Up to 104 mm

Print Length

Up to 1,000 mm

Sensor

Transmissive(Fixed), Reflective(Adjustable),
Head open

Media Characteristics

Media Type

Gap, Black Mark, Notch, Continuous,
Fan-Fold

Media Width

15 ~ 118 mm

Media Roll Diameter

Up to 127 mm

Media Thickness

0.06 ~ 0.20 mm

Supply Method

Easy Paper Loading

Inner Core

25.4 ~ 38.1mm

Physical Characteristics

Dimensions (WxDxH)

181 x 222 x 168 mm
(7.13 x 8.74 x 6.62 inch)

Weight

1.7kg (3.75 lbs.)

Power

EnergyStar Certified,
External Power Adaptor 100-240V AC,
50/60Hz

Guide

Combined paper holder and guide

Performance Characteristics

Memory

64 MB SDRAM, 128 MB Flash

Interface

Standard: USB

Optional: USB + Serial + Ethernet

Environment Characteristics

Temperature

Operating: 0 ~ 40°C (32 ~ 104°F)

Storage: -20 ~ 60°C (-4 ~ 140°F)

Humidity

Operating: 10 ~ 80% RH

Storage: 10 ~ 90% RH

Software

Emulation

SLCS™, BPL-Z™, BPL-E™

Driver / Utility

- Windows Driver (Europlus/Seagull)
- Linux / Mac CUPS Driver
- Virtual COM USB/Ethernet Driver
- Utility Program
- OPOS Driver
- Bartender Ultralite for BIXOLON
- Label Artist™-II

SDK

- Windows SDK
- Linux SDK

Fonts / Graphics / Symbologies

Fonts

- 10 SLCS™ Resident Bitmap Fonts
- One SLCS™ Resident Scalable Font
- 16 BPL-Z™ Resident Bitmap Fonts
- One BPL-Z™ Resident Scalable Font
- 5 BPL-E™ Resident Bitmap Fonts
- 23 Code Page
- Unicode supported
(UTF-8, UTF-16LE, UTF-16BE)

Graphics

Supporting user-defined fonts, graphics,
formats and logos

Barcode Symbologies

- 1D: Codabar, Code 11, Code 39, Code 93,
Code 128, EAN-13, EAN-8, Industrial
2-of-5, Interleaved 2-of-5, Logmars, MSI,
Plessey, Postnet, GS1 DataBar (RSS-14),
Standard 2-of-5, UPC/EAN extensions,
UPC-A, UPC-E, IMB
- 2D: Aztec, Codablock, Code49, Data Matrix,
MaxiCode, MicroPDF417, PDF417,
QR Code, TLC39

Accessories

Options

Peeler, External Paper Supply

